

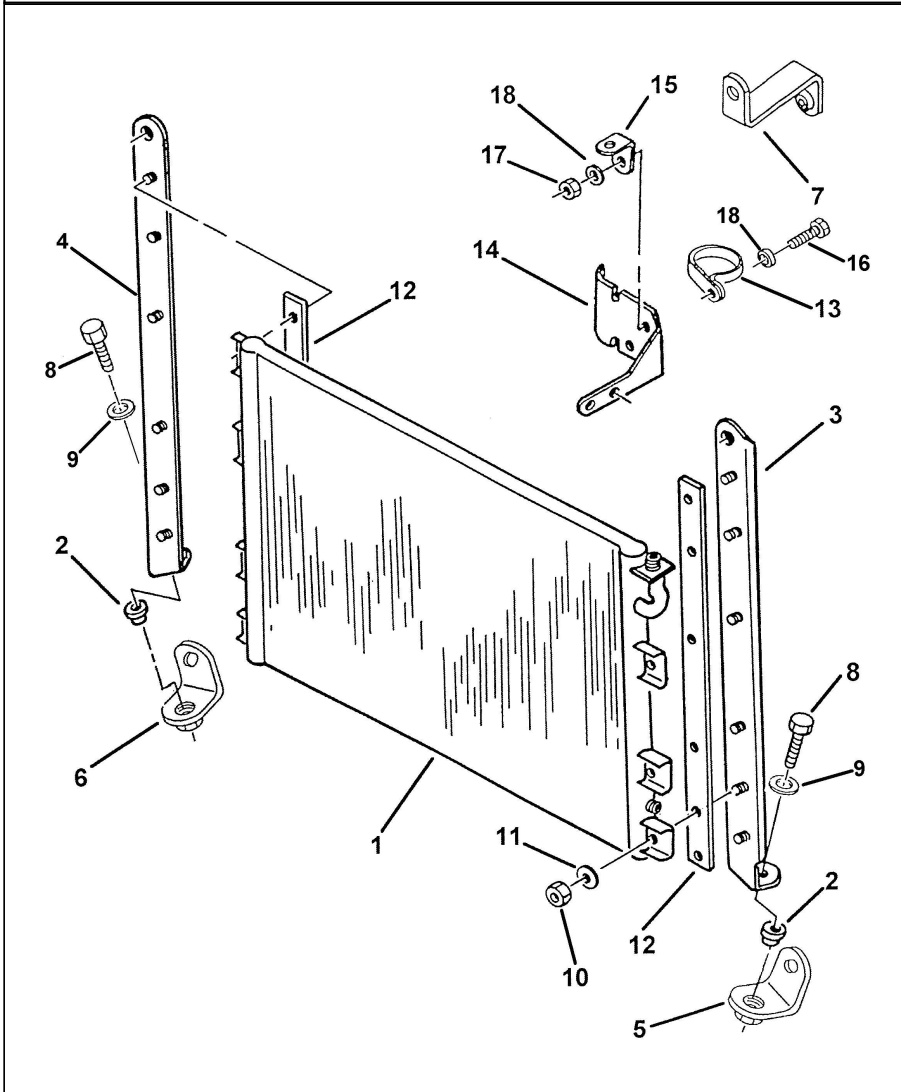



Unitglas Hood - W900L
1200 Sq. In. Radiator Mounted Condenser
w/ R-134a Refrigerant (0037-429-Q01)

97494



		Item No	Part No	Qty	Description & Remarks
	✓	1	K122-125	1	Condenser
	✓	2	K066-422	4	Bushing - Condenser
	✓	3	K275-6516-2	1	Bracket, Condenser, Steel, LH
	✓	4	K275-6516-2R	1	Bracket, Condenser, Steel, RH
	✓	5	K275-6519	1	"L" Bracket, Condenser, Steel, LH, w/ Nut
	✓	6	K275-6519R	1	"L" Bracket, Condenser, Steel, RH, w/ Nut
	✓	7	K275-6552	2	"S" Bracket, Condenser, Steel, w/ Nut
Ⓢ	✓	8	K041-803-30BK	4	Hex Bolt (M8 x 1.25 x 30mm), Black Black finish
Ⓢ	✓	9	K363-340-5-312BK	4	Flat Washer (5/16"), Stainless Steel Black Stainless steel w/black finish
Ⓢ		10	K169-154-6BK	10	Self Locking Hex Nut (M6 x 1.00), Black Stainless steel w/black finish
	✓	11	K363-340-3-250BK	10	Flat Washer (1/4"), Black Stainless steel w/black finish

		12	K207-989	2	Condenser Seal
		13	K077-123-8	1	Cushioned Clamp (1/2")
		14	K316-1209	1	Bracket - Receiver/Dryer
		15	K028-885-2	1	Anchor Bracket
		16	K041-803-25CA	2	Hex Bolt (M8 x 1.25 x 25mm)
		17	K169-163-8CA	2	Locking Hex Nut (M8 x 1.25)
		18	K363-338-2-312	4	Flat Washer (5/16")